

ED:A

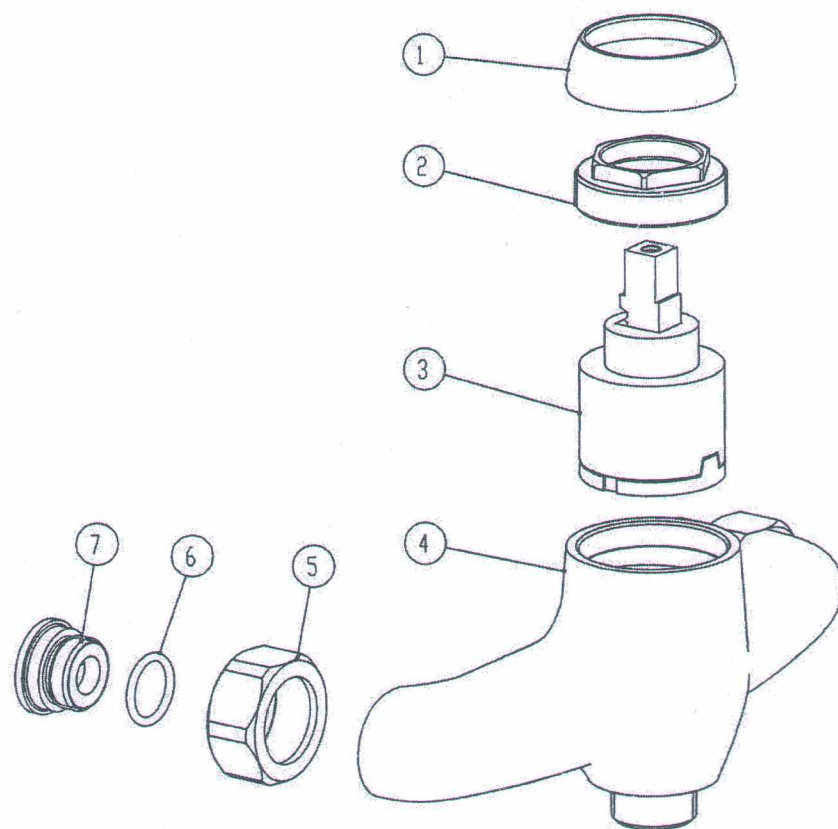

|            | Approved  | Date      | Signature     |
|------------|-----------|-----------|---------------|
| Novaservis | Cejpek F. | 15.5.2023 | <i>Cejpek</i> |
| Supplier   |           | 23.07.27  | 马子军           |

受控章

|     |          |         |              |       |     |          |
|-----|----------|---------|--------------|-------|-----|----------|
| 7   |          | 2510022 | Seat         |       | 2   | SUS304   |
| 6   |          | 2550021 | O-ring       | Ø14*2 | 2   | NBR      |
| 5   |          | 2510016 | Sleeve nut   |       | 2   | 57-3     |
| 4   | 92060-01 | 2130094 | Body         |       | 1   | CC757S*  |
| 3   |          | 2710002 | WH cartridge |       | 1   | 35D-2    |
| 2   | 92000-02 | 2020092 | CA Nut       |       | 1   | 57-3     |
| 1   | 92000-03 | 2020041 | Cover        |       | 1   | ABS      |
| NO. | PART.NO  | CODE    | PART NAME    | Model | QTY | Material |

|      |      |      |        |  |                |  |     |
|------|------|------|--------|--|----------------|--|-----|
| 08   |      |      |        | Tolerances for linear and diameter dimensions without individual tolerance indications ISO 2768-m<br>Tolerances for radius and chamfer without individual tolerance indications - ISO 2768-m |                | Title<br><b>novaservis</b><br>SHOWER MIXER |     |
| 07   |      |      |        |  |                |  |     |
| 06   |      |      |        | Date   | None           | No DRW<br>92 060-00                        |     |
| 05   |      |      |        | Drawn  | 7.3.2023       |  |     |
| 04   |      |      |        | Chen Bo  |                | A3   |     |
| 03   |      |      |        | Material   |                |  |     |
| 02   |      |      |        | Weight(g)  | 570            | Rev.                                       |     |
| 01   |      |      |        | Surface (dmg)  |                |  |     |
| Rev. | None | Date | Change | Kod B7   | 00920249900000 | Scale                                      | 1:1 |
|      |      |      |        |  |                | Made 1 of 1                                |     |

3.2

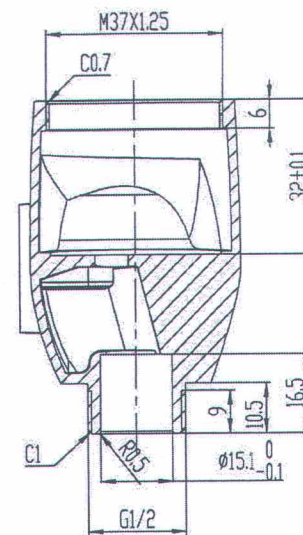
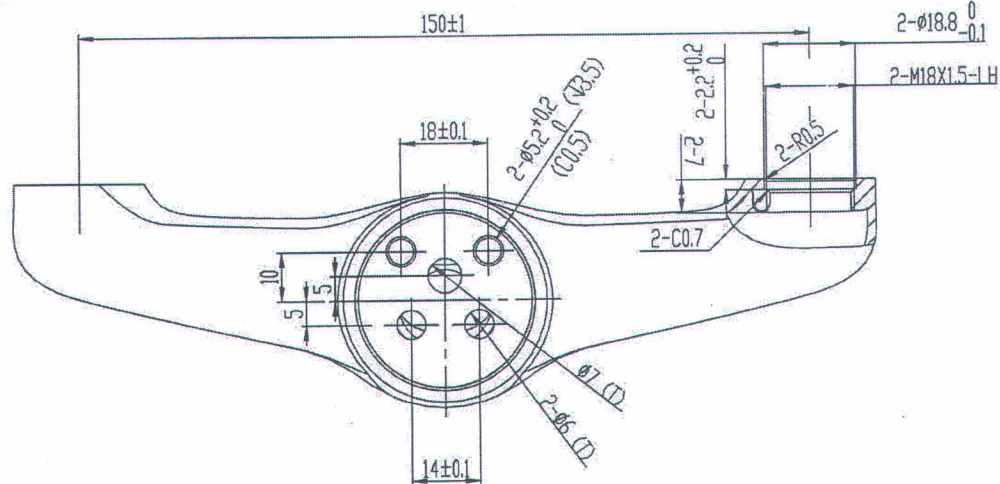
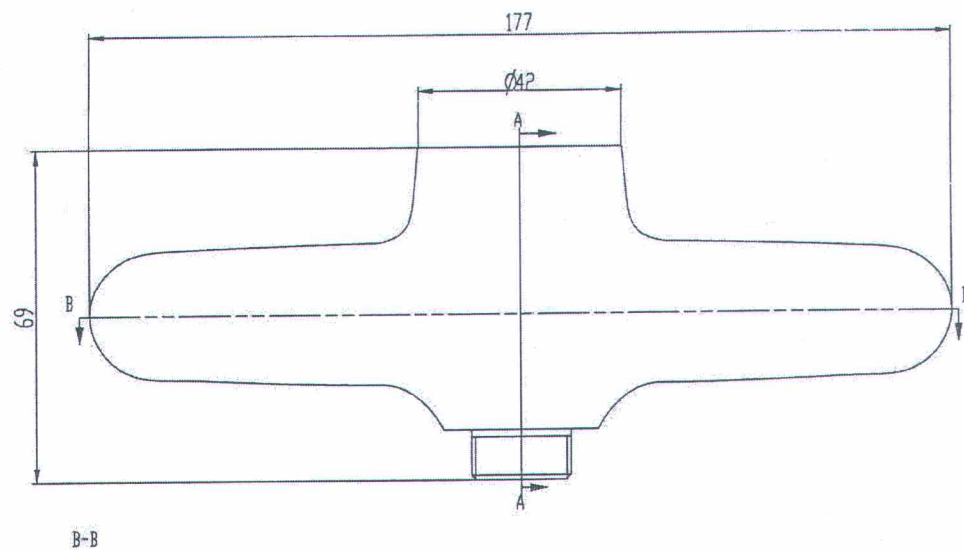

A-A  
1:1

受控章

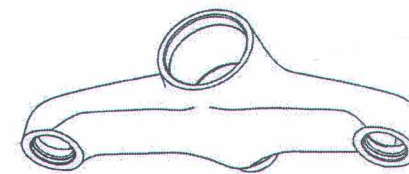

Polished, Chrome-plated (thickness Ni. 5 microns and Cr 0,15 microns)

|            | Approved  | Date      | Signature     |
|------------|-----------|-----------|---------------|
| Novaservis | Cejpek F. | 17.7.2023 | <i>Cejpek</i> |
| Supplier   |           | 23.07.21  | <i>马子章</i>    |

|    |  |  |  |  |               |  |        |             |          |
|----|--|--|--|--|---------------|--|--------|-------------|----------|
| 08 |  |  |  | Tolerances for linear and diameter dimensions without individual tolerance indications: DIN 2518-n |               | novaservis   |        |             |          |
| 07 |  |  |  | Tolerances for radius and chamfer without individual tolerance indications: + 130 2518-n           |               |  |        |             |          |
| 06 |  |  |  | Date   | Name          | Title<br><br>Body<br><br><br>No. DRW<br>92 060-01<br>2130094<br>A3<br>Rev. |        |             |          |
| 05 |  |  |  | DRAW   | 7.3.2023      |  |        |             | Chris Jo |
| 04 |  |  |  | Materials  |               |  |        |             |          |
| 03 |  |  |  | C7575  |               |  |        |             |          |
| 02 |  |  |  | Weight   | 400           |  |        |             | Surface  |
| 01 |  |  |  | Rev.   | Name          | Date   | Change |             |          |
|    |  |  |  | Kod DR   | 0120509990000 | Scale  | 1:1    | Modell of 1 |          |